

LEGEND

MW	Water pressure gauge
RM	Manual water filling cap
SFA	Manual air vent
VSC	Water drain valve

LIFTING AND CARRIAGE PRECAUTIONS

- Check the weight on the CE label to select appropriate lift equipment .
- Before lifting the unit make sure that the external panel is firmly fixed in place.
- The movement must be performed with caution and avoid abrupt movements.
- Never move the unit on rollers.

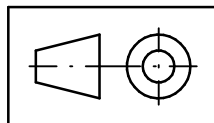

MOD.	EMPTY WEIGHT	OPERATING WEIGHT
ENR.003	85 kg	125 kg
ENR.004	90 kg	130 kg
ENR.005	95 kg	135 kg

Scala-Scale	Data-Date	Dis.to-Drawn	N°Pezzi	HITEMA [®]
	30/11/12	M. M.		
Peso-Weight Kg.	Materiali-Materials			
Denominazione-Denomination				DIS.-DRAW N.
WATER CHILLERS mod. ENR.003÷005				DIM-ENR-005ST01
Particolare-Detail				Rev.
Overall dimension - Lift Instruction				05-M.M.-29/12/16
REFRIGERNAT R410a				PROGRAM.N.